

# Premium Booth 3mW x 5mD Right Corner Booth

SD-E-15-R\_Cnr - 3mW x 5mD x 3.5mH

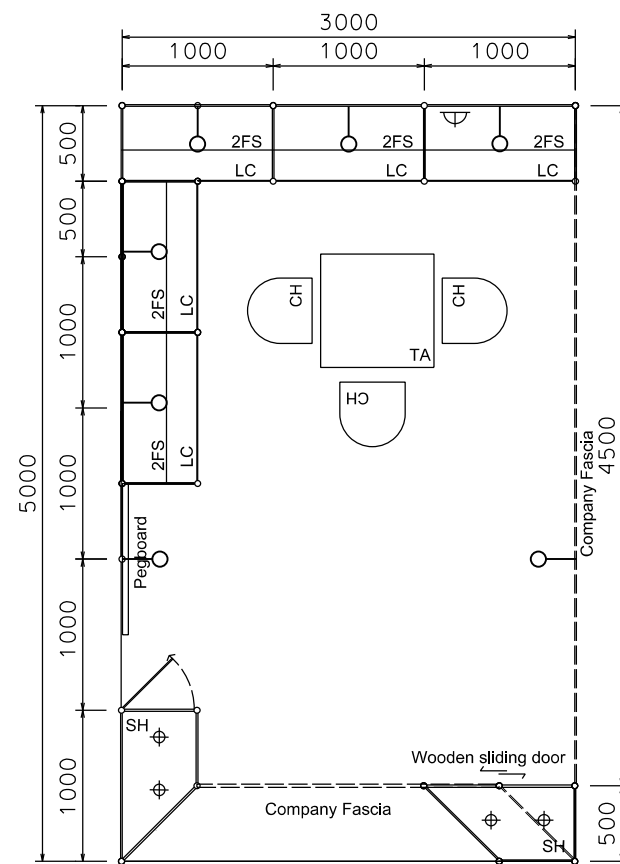

PLAN

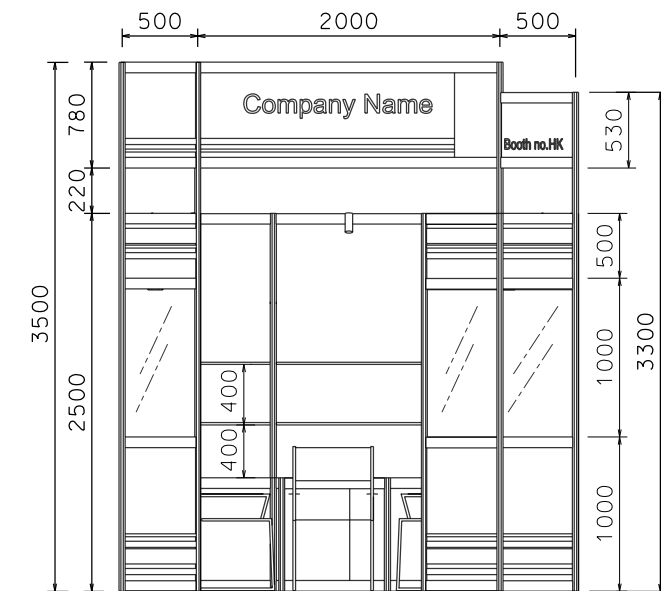

FRONT ELEVATION

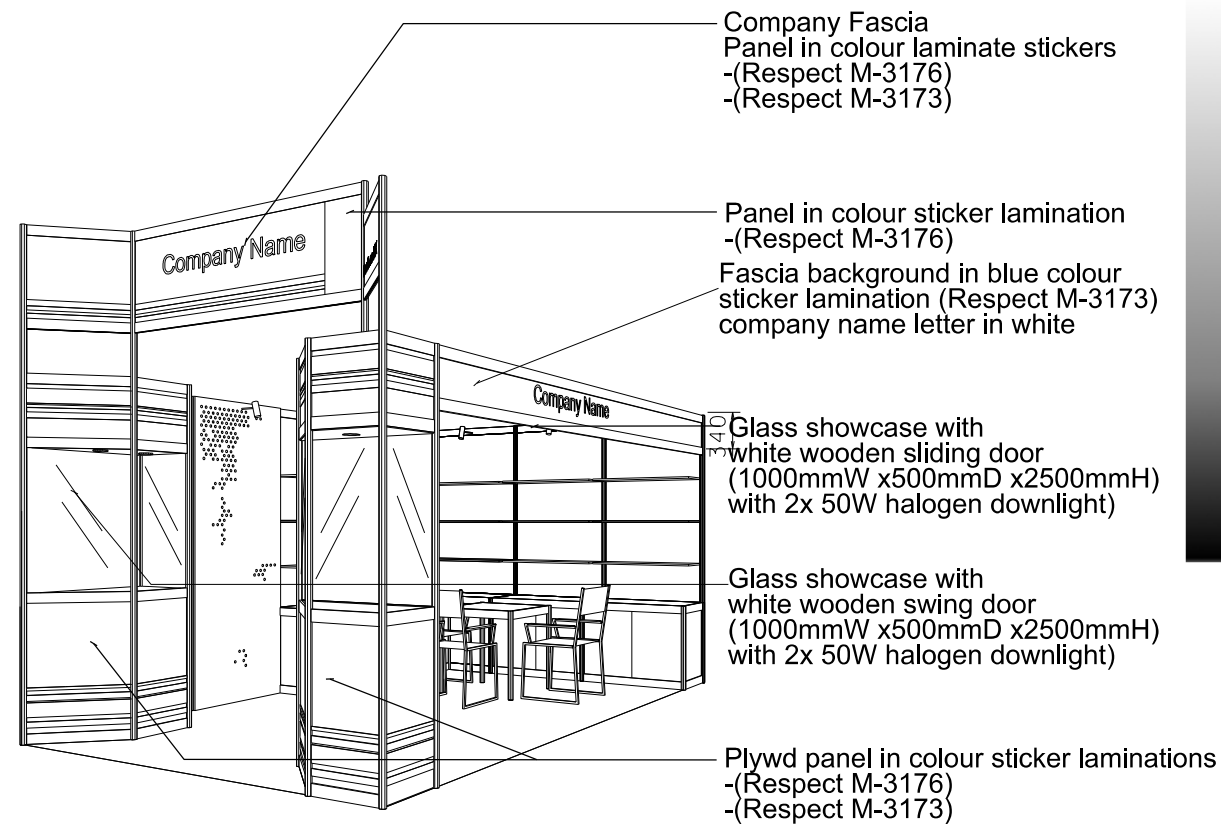

PERSPECTIVE N.T.S.

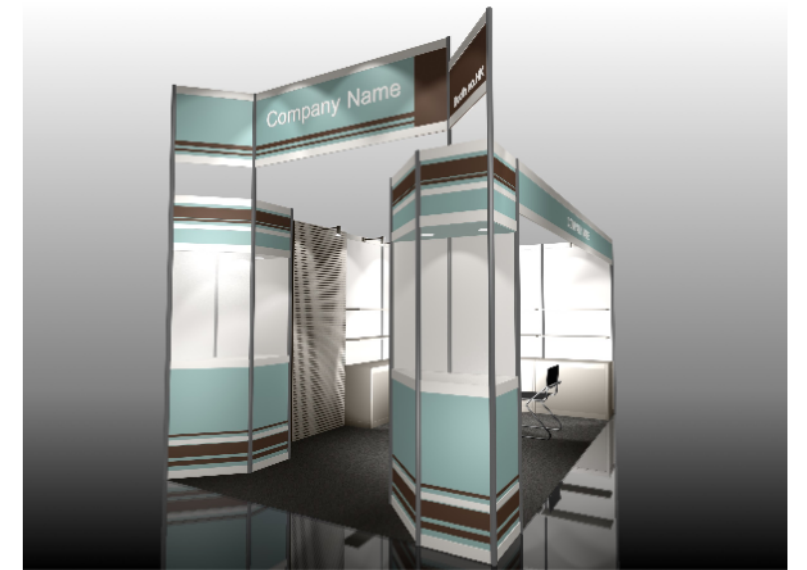

COLOUR PERSPECTIVE N.T.S.

BOOTH SPECIFICATION		QTY
	Front glass showcase in sticker lamination with white wooden swing door. 2 x (50W) halogen downlight (1m W x 0.5mD x 2.5m H)	1
	Front glass showcase in sticker lamination with white wooden sliding doors. 2 x (50W) halogen downlight (1m W x 0.5mD x 2.5m H)	1
	Lockable cabinet (1mL x 0.5mD x 0.75mH)	5
	Wooden shelf (flat) (1mL x 0.3mD)	10
	Pegboard with 30 hooks (1mW x 2.5mH)	1
	Square meeting table (0.7m X0.7m x 0.75mH)	1
	Black leather chair	3
	Longarmed spotlight w/23 watt energy saving lamp (yellow)	7
	800w Square pin power socket	1

FILE PATH - L:\Local Fair Premium Booth 2011\SD-Layouts(800w)\SD-E layout(800w)\SD-E-2dLayout(800w).dgn



NOTES UNLESS OTHERWISE SPECIFIED ALL DIMENSIONS ARE IN MM.

.....  
.....  
.....

.....  
.....  
.....

REVISION  
20-05-2009  
16-07-2009  
21-07-2009  
20-01-2010

DATE: 20-01-2010  
SCALE: 1 : 50 (A3)  
DRAWN BY: ..  
CHECKED BY: .....

TITLE  
Premium Booth  
SD-E-15  
R-Corner

PROJECT  
PREMIUM BOOTH  
3m x 5m  
Corner  
DATE: XXXXXXXX

SHEET  
SD-E03a