

Premium Booth 3mW x 5mD Left Corner Booth

SD-E-15-L_Cnr - 3mW x 5mD x 3.5mH

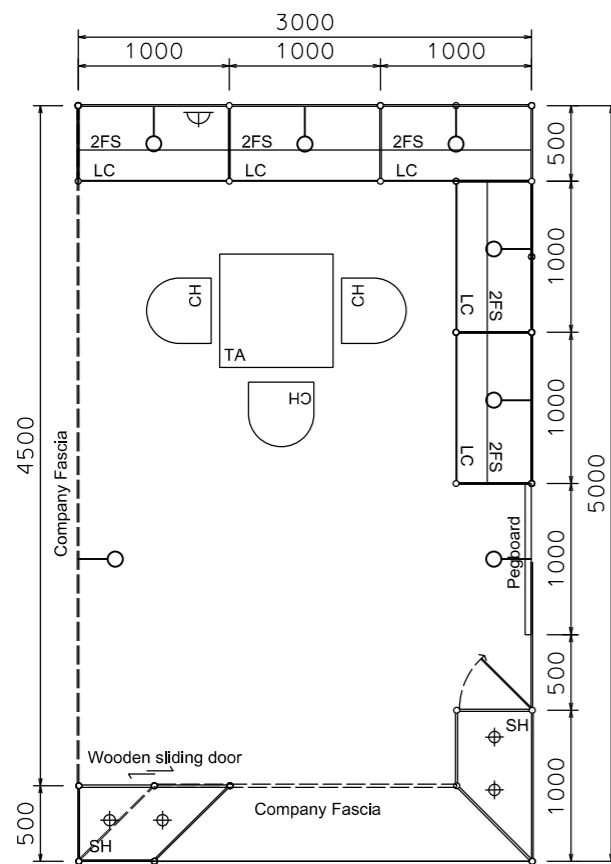

PLAN

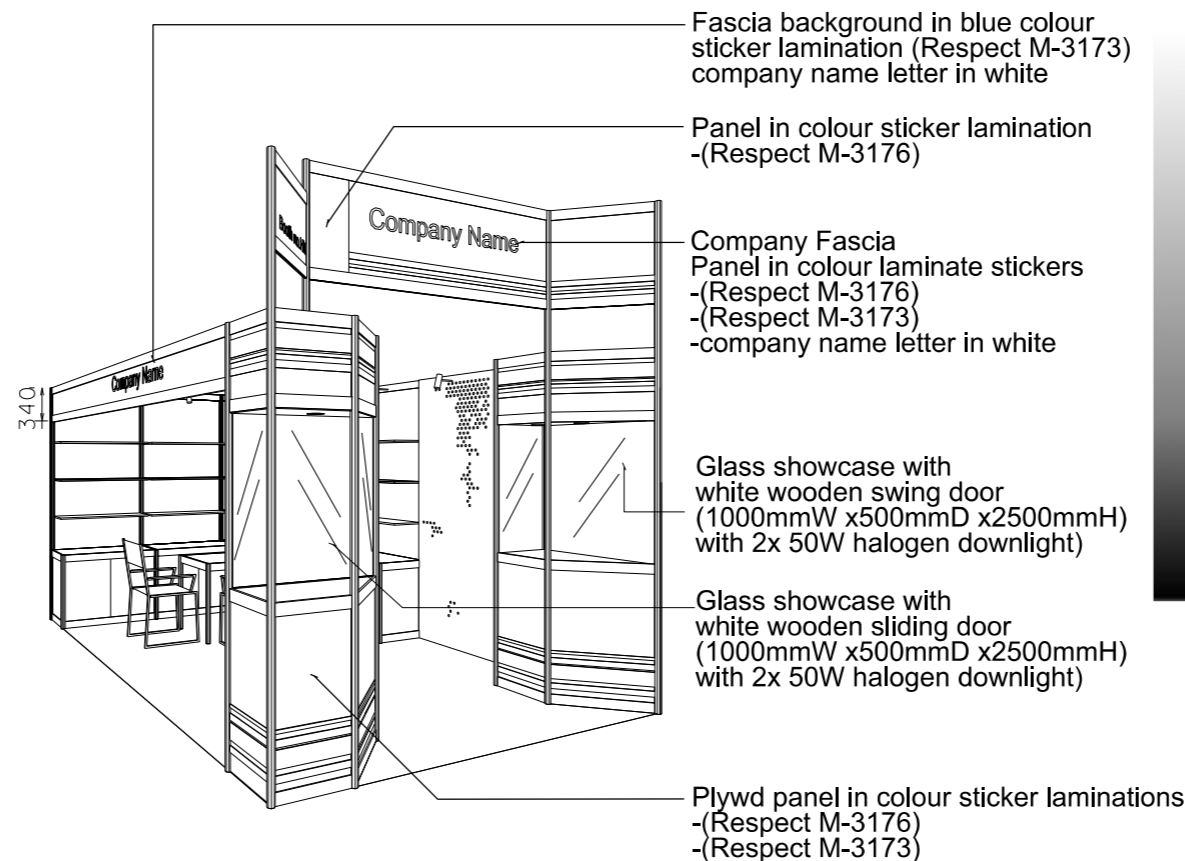

PERSPECTIVE N.T.S.

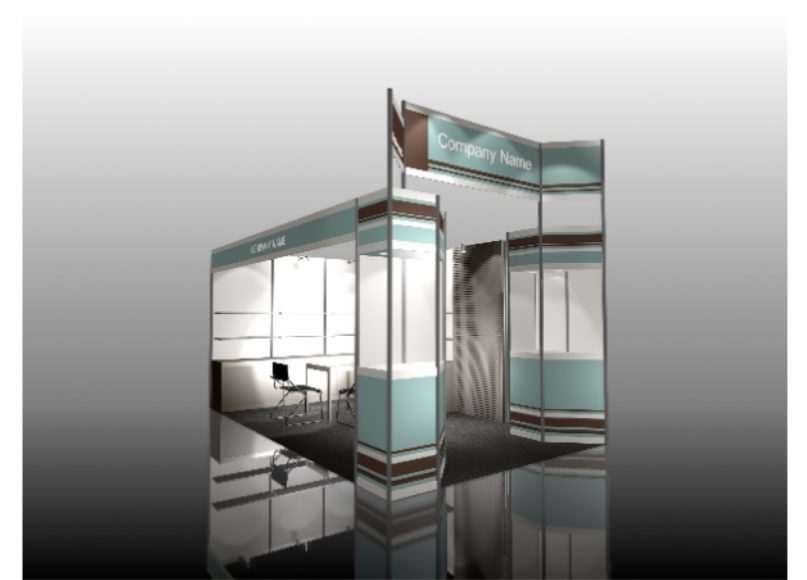

COLOUR PERSPECTIVE N.T.S.

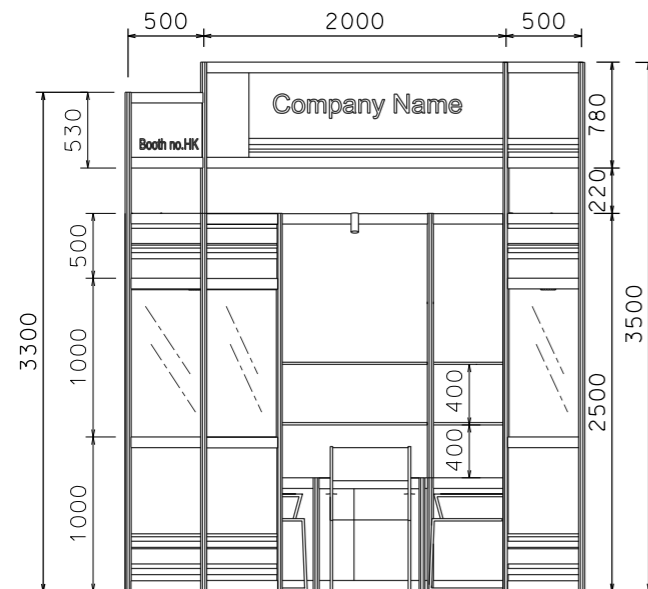

FRONT ELEVATION

BOOTH SPECIFICATION		QTY
	Front glass showcase in sticker lamination with white wooden swing door. 2 x (50W) halogen downlight (1m W x 0.5mD x 2.5m H)	1
	Front glass showcase in sticker lamination with white wooden sliding doors. 2 x (50W) halogen downlight (1m W x 0.5mD x 2.5m H)	1
	Lockable cabinet (1mL x 0.5mD x 0.75mH)	5
	Wooden shelf (flat) (1mL x 0.3mD)	10
	Pegboard with 30 hooks (1mW x 2.5mH)	1
	Square meeting table (0.7m X0.7m x 0.75mH)	1
	Black leather chair	3
	Longarmed spotlight w/23 watt energy saving lamp (yellow)	7
	800w Square pink power socket	1

FILE PATH - L:\Local Fair Premium Booth 2011\SD-Layouts(800w)\SD-E layout(800w)\SD-E-2dLayout(800w).dgn



NOTES UNLESS OTHERWISE SPECIFIED ALL DIMENSIONS ARE IN MM.

REVISION
20-05-2009
16-07-2009
20-01-2010

DATE: 20-01-2010
SCALE: 1 : 50 (A3)
DRAWN BY: ..
CHECKED BY:

TITLE
Premium Booth
SD-E-15
L-Corner

PROJECT
PREMIUM BOOTH
3m x 5m
Corner
DATE: XXXXXXXX

SHEET
SD-E03b